

NO TOOLS Installation!



No Tools



No Brackets



Installs in Seconds

Simple Fit® - the Easiest Custom Cellular Shade to Install.
Featuring a patented compression mount system, Simple Fit installation is complete with the touch of a button in less than 30 seconds without the need for tools or brackets.

1.

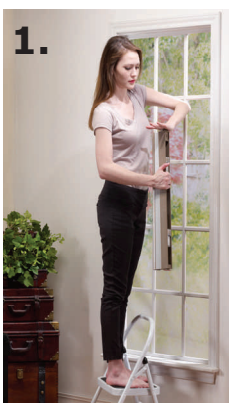

Step 1: Preparation

Simply depress the Trigger End (right) of the Simple Fit system by firmly pressing the mounting plate with the palm of your hand. It is engaged and properly in place when you hear an audible "click".

Step 2: Position

Peel the adhesive liner from each mounting plate. Place the Fixed End (left side) of the shade in the desired location and then raise and place the Trigger End (right side) into position.

2.

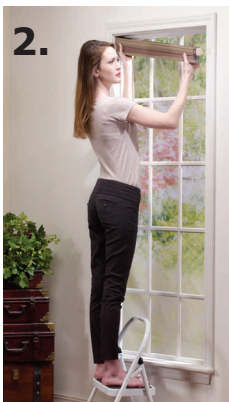

Step 3: Trigger Release Installation

Press the Trigger inward (towards the window glass) to activate the Simple Fit system. The compression based system will release to engage with your window frame creating a secure hold. A "slap" sound may be heard when the system engages with the window frame.

3.



Visual Check

The installed shade should have a standard gap of 1/4" on either side. Inspect the Trigger End to ensure that a red warning line does not appear. If a red line is visible, simply remove the shade and reinstall using the Spacer included in the installation packet.

