

SOLANA RETRACTABLE AWNING

Installation Instructions

Tools Needed

Drill

¼" Drill Bit

Lag Bolts
*to mount awning
brackets to wall*

Sockets or wrench to
*tighten non-provided
installation hardware*

Level

Caulking Measuring

Tape

4 mm Allen Key

CONGRATULATIONS on the purchase of a Blindsgalore Solana Retractable Awning.

Thank you for your business. Please read this entire manual before beginning installation.

We are confident you will enjoy many years of shade and worry free operation from your awning. This installation manual will outline the steps required to install your awning. It is important that the awning is installed properly to ensure worry free operation. Improper installation may cause damage or failure not covered by your warranty.

Mounting hardware is not included because it is different for every attachment surface. Please seek out professional advice in order to determine proper installation hardware selection.

If you are having any issues with the installation or determining mounting hardware please call 877-702-5463 for assistance from one of our shade experts.

Please be sure to be cautious in removing packaging materials. The fabric is just below the packaging material and can easily be damaged.

Never use a knife to remove packaging.

1 Mounting Brackets must be installed into solid structure (wood beams, studs, concrete, and/or roof rafters), sufficient to support the weight and anticipated wind load. (Note: it is highly recommended that the awning be retracted in moderate to strong wind conditions to prevent damage). Locate stud, beam or rafter and confirm that the structure is solid.

The awning can be either wall-mounted or ceiling-mounted. The instructions provided below are for wall mounting. If the procedure is different for ceiling installation, explanations will be provided as needed. This procedure must be performed by at least two workers.

2

SOLANA RETRACTABLE AWNING

Installation Instructions

INSTALLATION *cont.*

3

Before starting installation, take note of the following information, which is indispensable to find the right position for fastening the brackets:

Dimensions of the awning (height and width of box)

Protrusion of awning when opened or closed)

Side of awning where control is located

Dimensions of the wall/ceiling where the awning is to be installed.

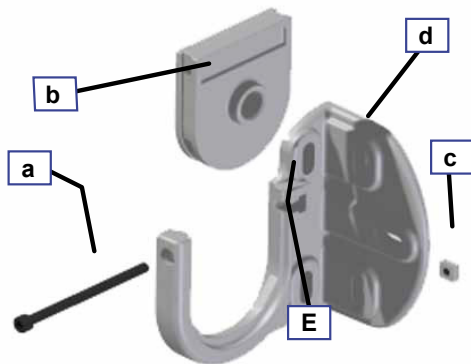

4

Make a hole with a drill bit that is suitable for the anchoring device.

Fasten the bracket (D) using the slots. Fasten the brackets to the wall: insert the plugs in the holes and secure the brackets with the screws and washers.

Position the roller tube insert (B) in both sides of the roller tube.

Position the tube with the inserts (B) in the wall/ ceiling support (D), insert the square nut (C) in the groove (E) and tighten the Allen head screw (A).



If the awning is to be installed on the CEILING, use the same brackets, and position them horizontally instead of vertically.

5

INSTALLATION OF ARMS

Fasten the tip of the arm to the front bar using the two screws provided with your Solana awning.

Fasten the arm bracket to the support surface (support wall).

DANGER TO OPERATOR! The arms are spring loaded, handle with care. Remove key only when the the arms have been securely attached. Handle the arms with care.

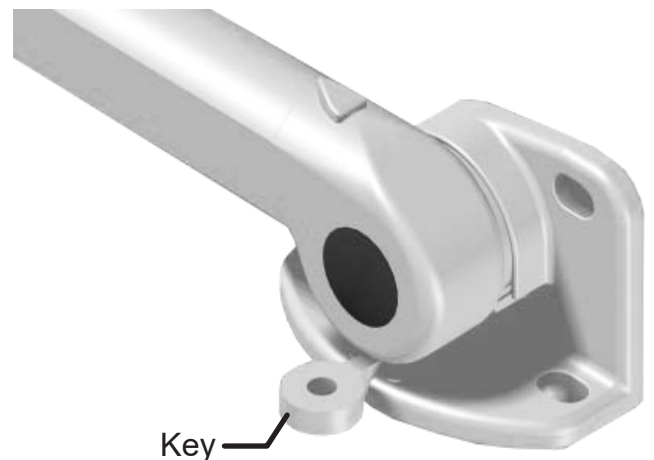

SOLANA RETRACTABLE AWNING

Installation Instructions

6 Hand Crank – Place hook of hand crank into the eyelet located at the bottom of the gear. Turn crank to extend the awning. Do not crank past the point of full extension, as fabric will slacken. Fabric must be retracted on the top of the roller tube, not the bottom.

Open and close the awning. Make sure the awning operates properly.

7

MOTORIZED SOLANA AWNING. Follow steps 1-5, then proceed to Adjusting motor limits.



Adjust Motor Limits

[NOTE: Motors come pre-programmed with short limits.]

To change the lower limit, send the motor to its current lower limit by pressing the down arrow.

Press both the up and down button at the same time until the motor jogs.

Adjust to your desired lower limit position and press the “my” button until the motor jogs.

This saves your lower limit. To change the upper limit, send the motor to its current upper limit.

Press both the up and down buttons at the same time until the motor jogs.

Adjust to your desired upper limit position and press the “my” button until the motor jogs. This saves your upper limit.



Confirm Limits

Send the shade to both the upper and lower limits.

The shade should roll up and down on cable guides and stop on its own at the programmed limit settings.

You're done!
Enjoy!